

HOW TO OPEN AND CLOSE A **DEUS II** REMOTE CONTROL (D2-RC)

You must work in a completely clean environment, free of dust and hair to ensure the waterproof function of this remote control. You will need:

- 1 x small flat screw driver
- 1 x Dynamometric screw driver + Torx 6 adapter
(model example: [WEERA](#) 05074700001 7440)
- 1 x small brush
- 1 x tissue in case you need to clean the screen
- Some silicone grease
(example: [Molykote](#) 55 O-Ring Grease)



HOW TO OPEN AND CLOSE A **DEUS II** REMOTE CONTROL (D2-RC)

Back of the remote control

- Using hair dryer or heat gun (carefully) apply gentle heat to serial number label to soften adhesive, using a craft knife gently lift a corner & peel off the sticker onto the blade, place safe for re-application.



S/N label

HOW TO OPEN AND CLOSE A **DEUS II** REMOTE CONTROL (D2-RC)

Back of the remote control

- On the bottom unscrew the screw #5. Keep it apart from other screws, this one is different.
- On top unscrew the 4 screws from the speaker grill #1 first, then the #3 , then #2 and finish by #4 and pay attention to the seal behind.



HOW TO OPEN AND CLOSE A **DEUS II** REMOTE CONTROL (D2-RC)

- Remove the speaker grill from the remote control. Pay attention to keep the rubber link in its housing and tilt the speaker grill there. (This avoids deforming the seal)
- You can use a flat screw driver to help you to remove the speaker grill, inserting slightly the screw driver in position #1



HOW TO OPEN AND CLOSE A **DEUS II** REMOTE CONTROL (D2-RC)

- Turn the remote control over on the table. The speaker will fall out.
- With the TORX 6 screw driver, remove the two screws on the bottom #6 and #7.



HOW TO OPEN AND CLOSE A **DEUS II** REMOTE CONTROL (D2-RC)

Remove D2-RC1-BOTTOM symmetrically from the D2-RC1-MAIN.



lift the bottom cover slightly ONLY at the ends ($\pm 3\text{mm}$ by levering between the rubber and the cover with a flat screwdriver for example)

HOW TO OPEN AND CLOSE A **DEUS II** REMOTE CONTROL (D2-RC)

- Slide down half of the PCB from the main body
- Disconnect the battery connector from the PCB.
- **Wait for 10 minutes.**

Battery connector



HOW TO OPEN AND CLOSE A **DEUS II** REMOTE CONTROL (D2-RC)

- **Align** the connector socket to the PCB and connect (**do not insert the connector askew = bad contact issue, charge issue...**)
- Insert the PCB inside the main body, making sure the screen is clean with no silicon grease on it..
- Check that connector cables do not cover the speaker contacts.



Do not insert
the connector askew

NOT OK

OK

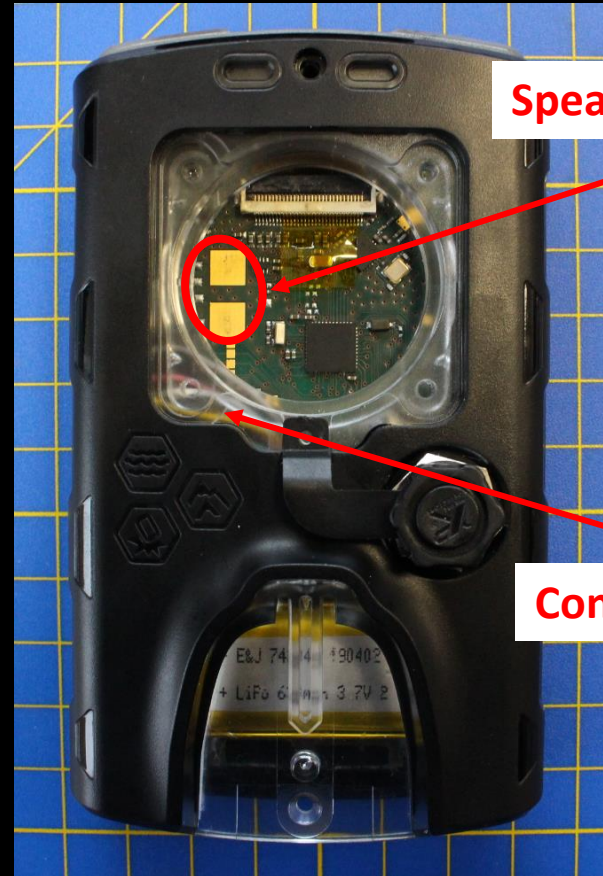

Speaker contacts

Connector cables

HOW TO OPEN AND CLOSE A **DEUS** *II* REMOTE CONTROL (D2-RC)

- Grease the D2-RC1-BOTTOM O-ring, with a brush and some silicone grease.
- Check the O-ring doesn't have any dust or hair, or brush hair.



HOW TO OPEN AND CLOSE A **DEUS II** REMOTE CONTROL (D2-RC)

- Insert D2-RC1-BOTTOM symmetrically to the D2-RC1-MAIN.



Once inserted, lift the cover slightly ($\pm 3\text{mm}$ by levering between the rubber and the cover with a flat screwdriver for example) remember **ONLY** at the end of the cover. Then push in fully again. This ensures that the seal is properly in its housing (not pinched).



HOW TO OPEN AND CLOSE A **DEUS** *II* REMOTE CONTROL (D2-RC)

- Put the speaker inside the main body. Take care to place the speaker in the right position. Match slot from the body and black pin from the speaker. (at « nine o'clock »)



**Slot and pin matching
At « nine o'clock »)**

HOW TO OPEN AND CLOSE A **DEUS II** REMOTE CONTROL (D2-RC)

- Assemble the speaker grill + seal to the D2-RC1-MAIN body. Pay attention to keep the rubber link in its housing and put the flat hood there. (This avoids deforming the seal)

1



2



3



HOW TO OPEN AND CLOSE A **DEUS II** REMOTE CONTROL (D2-RC)

- Clamp **all** the screws with the TORX 6x3.5 dynamometric screw driver (Torque= 0,30Nm) except the unique screw (#5) which need to be **manually** screwed **in the end of the process**
- Note that for the speaker grill, you need to clamp the screw #1 first, then the #3 , then #2 and finish by #4.



HOW TO OPEN AND CLOSE A **DEUS** *II* REMOTE CONTROL (D2-RC)

- Re-attach serial number label

Before



After

HOW TO OPEN AND CLOSE A **DEUS II** REMOTE CONTROL (D2-RC)

Congratulations the remote control is ready to use



The end